

**English for Young Learners
Teenagers
Vacation Students**

ENGLISHUK 
member

Accredited by the



for the teaching
of English in the UK





69 years' experience in teaching English to the world!

If you need a '5-star' programme, Anglo-Continental can provide it!

With 69 years of successful experience, we offer your son/daughter the chance to learn or improve their English in the best possible conditions - in England, in the care of skilled, professional teachers. Our courses are carefully designed to reflect the interests and capabilities of the various age groups. All our activities, from classroom lessons and language practice to games and creative leisure activities, are planned to ensure that they are instructive, enjoyable and safe. We look forward to welcoming your son/daughter.

A 5-star programme:

- Accredited by The British Council
- Lively, motivating, fun lessons where real progress can be made
- Outstanding programmes of guided excursions, sports and leisure activities
- Carefully selected homestay accommodation
- Comprehensive transport arrangements
- High standards of supervision and student care for students aged 10-16 years on the Young Learners and Teenagers Programme



Contents

	Pages
Welcome to Anglo-Continental	4 - 5
Welcome to Bournemouth	6 - 7
Young Learners and Teenagers Programme C-1.20, C-2.20, and C-3.30 Course C-1.20 Age 10 - 13 + 14 - 16 Course C-2.20 Age 10 - 13 + 14 - 16 Intensive Course C-3.30 Age 14 - 16	8 - 15
Vacation Programme V-1.20 and V-2.20 Course V-1.20 Age 16 - 20 Course V-2.20 Age 16 - 20	16 - 21
Accommodation	22
Safety and Student Support	23
Transfer services	24 - 25
Conditions of enrolment	26
Enrolment and payment form	27 - 28
Declaration form	29 - 30
General information	31



**Young Learner and
Vacation Students from
33 different countries
in 2018**

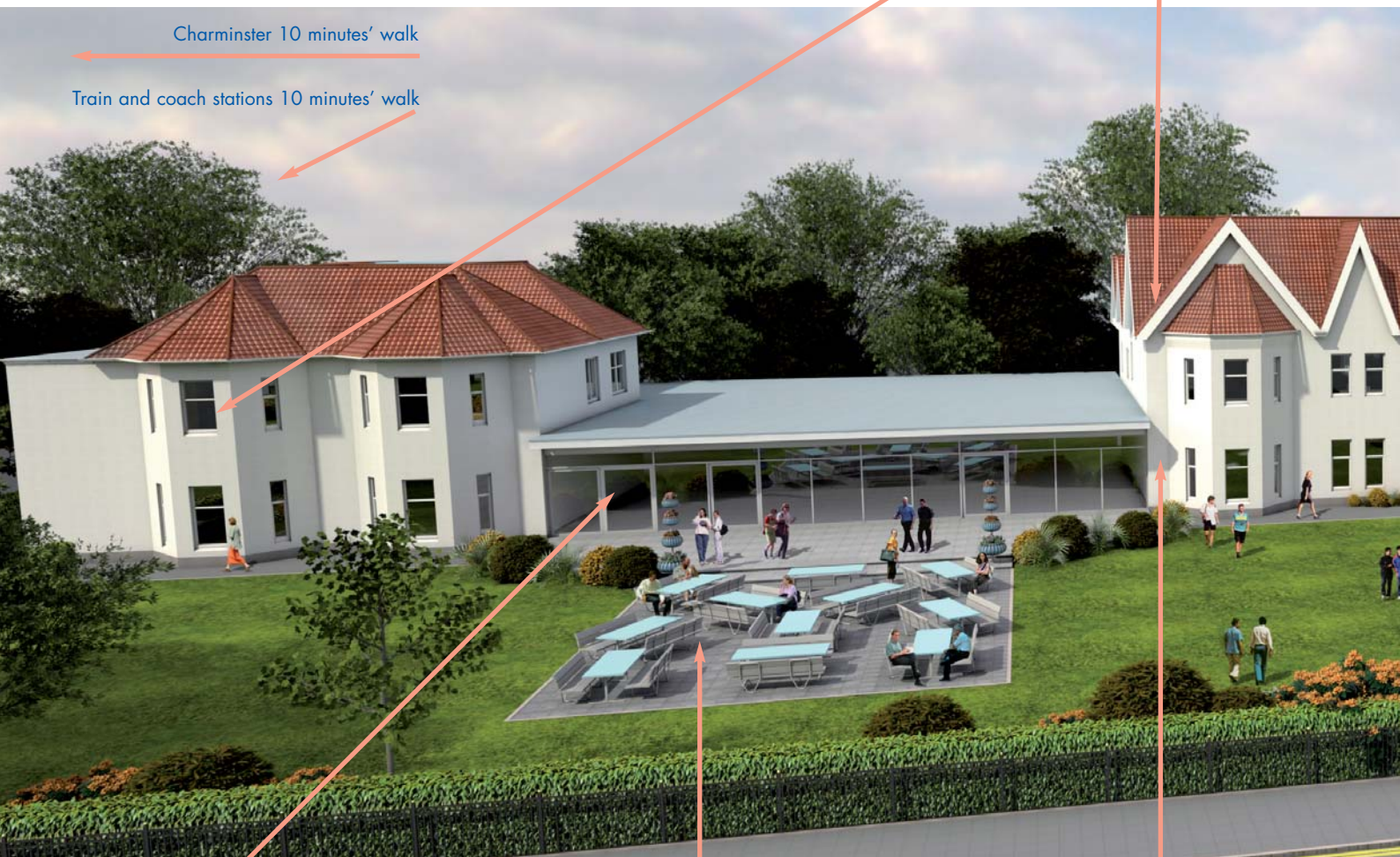



Multi-Media Learning Centre



Pavilion



Classrooms



Bournemouth Town Centre 10 minutes' walk
Bournemouth Beach 15 minutes' walk

Computer generated image as many large trees make it difficult to take a photograph of the entire campus.



Language Laboratory



Student Services



Lecture Room

Welcome to Bournemouth



Generations of young learners and vacation students from all parts of the world have happy memories of their time spent in Bournemouth with Anglo-Continental.

Bournemouth

Bournemouth is the most popular place to study English in the UK, outside of the capital. It is an attractive university town and one of the most popular holiday resorts on the south coast of England. It is conveniently close to London and its airports by train or motorway. Bournemouth has modern shops and stores in safe pedestrian precincts, 800 hectares of delightful parks and gardens, and 12 kilometres of clean, sandy beaches - with the prestigious Blue Flag awarded for cleanliness and safety. The town

also provides excellent facilities for sport, leisure and entertainment.

Located in an area of outstanding natural beauty, Bournemouth is ideally situated as a base for weekly visits and excursions to places of interest. It is the perfect place in which to combine enjoyable learning with a safe, exciting holiday.

Our Location

The Anglo-Continental campus in Wimborne Road, Bournemouth, has a separate school building dedicated exclusively to our young learners. There are excellent educational facilities, with recreational areas on the campus and nearby.

th...



© Bournemouth Tourism



English for Young Learners and Teenagers



Choice of courses

Choose from the following Young Learners and Teenagers Courses:

- English language and activity course (20 lessons per week)
- Intensive English language and educational activity course (28 lessons per week)

Classes

Your son/daughter will study in a lively international atmosphere with others whose levels of English are similar. Your son/daughter will be taught by a team of two or three teachers, who encourage participation and interaction between members of the group - and English will be the only language used!

Lessons

The lessons will be stimulating and effective, with a variety of activities to develop your son/daughter's confidence, knowledge and skills:

- lively presentation and practice of new language
- rapid development of oral fluency, accuracy and conversation skills
- systematic development of listening, reading and writing skills
- extension of vocabulary, structure and usage

If your son/daughter follows an intensive course of 28 lessons per week, he/she will have the additional benefit of a language extension programme with an intensive academic approach.

Excursions, Sports and Leisure Activities

A wide variety of excursions, sports and leisure activities are an integral part of the programme. Students develop their language during activities and excursions using quizzes and worksheets about the destination or activity. Excursions and activities are also followed up in class and students are encouraged to develop language through their experiences.



Safety and Student Support

The safety and wellbeing of our students is one of our top priorities.

Anglo-Continental has fully trained staff and facilities to provide a high standard of student support, safety and first aid.

Anglo-Continental operates a 24/7 helpline for emergencies.

Telephone:

(GB code) +(0)1202 55 74 14
or (GB code) +(0)78 3161 3193
(out of office hours only).

January
February
April

Young Learners and Teenagers Programme

English Language and Activity Course 2019

Course number	C-1.20	
Course type	English Language and Activity Course	
Lessons per week <small>(lesson duration: 45 minutes)</small>	20	
Language levels for entry	Beginner* to Advanced	
CEFR levels for entry	A1* - C1	
Class size	Average 13 (max.15)	
Age groups	10 - 13 and 14 - 16	
Course duration (weeks)	January = 2 - 5 April = 2 - 4	
Full day excursions	1 per week	
Daytime leisure activities	5 per week	
Arrival and departure transfers	At extra cost see pages 24 - 25	
Courses held between	7 January - 9 February 1 - 27 April	New dates
Course fees	Pounds sterling	
First 2 weeks	815	
Each additional week	335	
Homestay accommodation fees - twin room (Pounds sterling)	Age: 10 - 13	Age: 14 - 16
First 2 weeks	618	462
Each additional week	279	201
Supervised door-to-door car service to/from centre 6 return journeys per week	Included	Optional 78 per week
Guardianship fee for under 16's studying for 4 weeks or more (per week)	20	20

Course fees include...

- Enrolment fee
- Entry test
- Tuition
- Teaching materials
- Student card
- Certificate of Studies
- Orientation tour on the first day
- Wi-Fi
- Sports and leisure activities
- Excursions (including entrance fees)

Accommodation fees include...

- Twin room - from the Sunday before course commencement to the Sunday after its completion
- Light laundry service
- Wi-Fi

Meals

- Lunch from Monday to Friday is taken at the centre. The homestay family will provide a packed lunch for the excursion on Saturday. All other meals are taken with the homestay family.
- Students who do not have homestay accommodation are required to pay £ 35 per week for meals and supervision.

Please note

- English language lessons and sports/leisure activities may alternate between mornings and afternoons on a weekly basis.

Individual Tutorials

Anglo-Continental can arrange tutors to support your son/daughter's studies based on the UK educational curricula. Subjects include, but are not limited to:

- Art and Design
- Biology
- Business Studies
- Chemistry
- Economics
- English
- Further Mathematics
- General Studies
- Geography
- History
- ICT
- Mathematics
- Media/Film/TV
- Music
- Physics
- Psychology
- Sociology

Tutorials are £ 76 per 45 minute session. Please contact us for availability of tutors.

Course entry dates 2019

C-1.20

January
7*, 14,
21, 28

April
1*, 8,
15

* Beginners may start their courses only on the entry dates marked with asterisks (*)

**June
July
August**

Young Learners and Teenagers Programme

English Language and Activity Course 2019

Course number	C-2.20	
Course Type	English Language and Activity Course	
Lessons per week (lesson duration: 45 minutes)	20	
Language levels	Beginner* to Advanced	
CEFR levels	A1* - C1	
Class size	Average 13 (max.15)	
Age groups	10 - 13 and 14 - 16	
Course duration (weeks)	2 - 12	
Full day excursions	1 per week	
Half day excursions	1 per week	
Daytime leisure activities	4 per week	
Evening leisure activities	2 per week	
Arrival and departure transfers	At extra cost see pages 24 - 25	
Courses held between	3 June - 24 August	
Course fees	Pounds sterling	
First 2 weeks	975	
Each additional week	415	
Homestay accommodation fees Twin Room (Pounds sterling)	Age: 10 - 13	Age: 14 - 16
First 2 weeks	748	592
Each additional week	344	266
Supervised door-to-door car service to/from centre 6 return journeys per week	Included	Optional 78 per week
Guardianship fee for under 16's studying for 4 weeks or more (per week)	20 per week	20 per week

Course fees include...

- Enrolment fee
- Entry test
- Tuition
- Teaching materials
- Student card
- Certificate of Studies
- Orientation tour on the first day
- Wi-Fi
- Sports and leisure activities
- Excursions (including entrance fees)

Accommodation fees include...

- Twin room - from the Sunday before course commencement to the Sunday after its completion
- Light laundry service
- Wi-Fi

Meals

- Lunch from Monday to Friday is taken at the centre. The homestay family will provide a packed lunch for the excursion on Saturday. Two evening meals are taken at the centre. All other meals are taken with the homestay family.
- Students who do not have homestay accommodation are required to pay £ 49 per week for meals and supervision.

Please note

- English language lessons and sports/leisure activities may alternate between mornings and afternoons on a weekly basis.

Course entry dates 2019 C-2.20

June	July	August
3, 10, 17*, 24	1, 8*, 15, 22, 29*	5, 12

* Beginners may start their courses only on the entry dates marked with asterisks (*)

"The host family I live with treats me well and helps me to learn the way of life in Bournemouth."
Nibras, Oman

All entrance fees are included in the course fees



London Eye

Typical full-day excursions selected from:

- London tours by coach including sightseeing. These excursions may also include:
 - walking tour, Thames boat trip and Tower of London
 - visit to the London Dungeon
 - visit to the London Eye
 - visit to the Natural History/Science Museum
 - visit to Ripley's Believe It or Not!
- Bristol and Brunel's ss Great Britain ship
- Longleat Safari Park
- The City of Bath and Stonehenge
- Wookey Hole Caves and Papermill
- Brighton and the Royal Pavilion
- Harry Potter Studio Tour near London
- Stratford-upon-Avon and Warwick Castle
- Thorpe Park - Theme park with rollercoasters and attractions
- Portsmouth - HMS Victory ship and shopping at Gunwharf Quays
- The University City of Oxford - visit to Christ Church College and shopping



Typical half-day excursions selected from:

- Activate Indoor Trampoline Park
- Altitude High Ropes Adventure at Littledown Park
- Poole Harbour Boat Cruise to Brownsea Island
- Rock Reef on Bournemouth Pier - Adventure Activity Centre
- Hengistbury Head Outdoor Education Centre
- Monkey World - Ape Rescue Centre
- Snowtrax - The Alpine Activity Centre
- Splashdown Waterpark
- Moors Valley Country Park
- The Jurassic Coast
- Rockley Watersports
- Swanage Railway
- Corfe Castle



Lulworth Cove

Typical sports and creative leisure activities selected from:

- | | | |
|-------------------------------------|--------------------------|-------------------------------|
| - Walking tour of Bournemouth | - Disco | - Indoor games |
| - New age kurling | - Competitions | - Digital scavenger hunt |
| - Bushcraft outdoor survival skills | - Photography challenge | - Arts and crafts |
| - Mini golf | - Movie making | - Beach games |
| - Volleyball | - Bournemouth Oceanarium | - Ten-pin bowling |
| - Football | - Cinema | - Ceramic art workshop |
| - Tennis | - Five-a-side football | - Dancing |
| - Basketball | - Summer fete | - Cake decorating competition |
| - Swimming | - Summer ball | - British party games |
| - Table tennis | - Talent show | - Laser Quest |
| - Ice skating | - Anglo party | - Drama workshop |
| - Treasure hunt | - Shopping trip | - Fashion show |
| - Anglo olympics | - Themed events | - Karaoke |
| | - Quizzes | |



Ten-Pin Bowling

June
July
August

Intensive Teenagers Programme

Intensive English Language and Activity Course 2019

Course number	C-3.30
Course Type	Intensive English Language and Activity Course
Lessons per week (lesson duration: 45 minutes)	28
Language levels	Pre-Intermediate to Advanced
CEFR levels	A2 - C1
Class size	Average 13 (max.15)
Age groups	14 - 16
Course duration (weeks)	2 - 7
Full day excursions	1 per week
Half day excursions	1 per week
Daytime leisure activities	4 educational activities per week
Evening leisure activities	2 per week
Arrival and departure transfers	At extra cost see pages 24 - 25
Courses held between	17 June - 3 August
Course fees	Pounds sterling
First 2 weeks	1105
Each additional week	480
Homestay accommodation fees Twin Room (Pounds sterling)	Age: 14 - 16
First 2 weeks	592
Each additional week	266
Supervised door-to-door car service to/from centre 6 return journeys per week	Optional 78 per week
Guardianship fee for under 16's studying for 4 weeks or more (per week)	20 per week

Course fees include...

- Enrolment fee
- Entry test
- Tuition
- Teaching materials
- Student card
- Certificate of Studies
- Orientation tour on the first day
- Wi-Fi
- Sports and leisure activities
- Excursions (including entrance fees)

Accommodation fees include...

- Twin room - from the Sunday before course commencement to the Sunday after its completion
- Light laundry service
- Wi-Fi

Meals

- Lunch from Monday to Friday is taken at the centre. The homestay family will provide a packed lunch for the excursion on Saturday. Two evening meals are taken at the centre. All other meals are taken with the homestay family.
- Students who do not have homestay accommodation are required to pay £ 49 per week for meals and supervision.

Please note

- English language lessons and sports/leisure activities may alternate between mornings and afternoons on a weekly basis.

Course entry dates 2019

C-3.30

June 17, 24	July 1, 8, 15, 22
----------------	-------------------------

* Beginners may start their courses only on the entry dates marked with asterisks (*)

"I love that all of the activities are completely different in this school. Everyday you learn and do something new."

Eva, Russia

All entrance fees are included in the course fees



Educational activities with weekly themes:

Week 1: Film-Making

Stop motion filming, story-boarding, film editing and movie trivia quiz. Watching stop motion movies and review.

Week 2: Music

Lyric training, song writing, using instruments to record backing track. Recording, rehearsal, performance, recording and review.

Week 3: Fashion

Design vocabulary, design and creation of fashion items and photoshoot. Design of logo and logo quiz. Catalogue creation using photographs and descriptions.

Week 4: Drama

Selecting a play and casting. Costume, rehearsal and performance. Record and review performance.

Week 5: Product Design and Technology

Designing a product. Taking photographs of the product. Creating an advertising campaign. Persuasive writing skills. Sales presentation and demonstrations.

Week 6: Information and Communications Technology

Learn computer vocabulary. An introduction to coding using "Scratch". Presentations using Powerpoint and Prezi effectively. Demonstrations of coded projects.

Week 7: Science

Writing science questions for a quiz. Team experiments. Following written instructions. Beach scavenger hunt.



Typical full-day excursions selected from:

London tours by coach including sightseeing. These excursions may also include:

- walking tour, Thames boat trip and Tower of London
- visit to the Natural History/Science Museum
- Chessington World of Adventures
- Longleat Safari Park
- The City of Bath and Stonehenge
- Wookey Hole Caves and Papermill
- Thorpe Park - Theme park with rollercoasters and attractions
- Portsmouth - HMS Victory ship and shopping at Gunwharf Quays
- The University City of Oxford - visit to Christ Church College and shopping



Typical half-day excursions selected from:

- Poole Harbour Boat Cruise to Brownsea Island
- Hengistbury Head Outdoor Education Centre
- Monkey World - Ape Rescue Centre
- Moors Valley Country Park
- The Jurassic Coast
- Rockley Watersports
- The coastal town of Swanage





Typical Timetables

The detailed excursion and activity programmes are available 6 months before course commencement: www.anglo-continental.com/young-learners.html

Young Learners and Teenagers Course C-1.20 January, February and April		
Monday	07.30 - 08.00 08.45 - 12.15 12.15 - 13.15 13.15 - 16.30 Evening	Breakfast with the Host Family Lessons Lunch at the Centre Ice Skating Dinner + Evening with the Host Family
Tuesday	07.30 - 08.00 08.45 - 12.15 12.15 - 13.15 13.15 - 16.30 Evening	Breakfast with the Host Family Lessons Lunch at the Centre Movie Making Dinner + Evening with the Host Family
Wednesday	07.30 - 08.00 08.45 - 12.15 12.15 - 13.15 13.15 - 16.30 Evening	Breakfast with the Host Family Lessons Lunch at the Centre Laser Quest Dinner + Evening with the Host Family
Thursday	07.30 - 08.00 08.45 - 12.15 12.15 - 13.15 13.15 - 16.30 Evening	Breakfast with the Host Family Lessons Lunch at the Centre Anglo Cinema and Movie Quiz Dinner + Evening with the Host Family
Friday	07.30 - 08.00 08.45 - 12.15 12.15 - 13.15 13.15 - 16.30 Evening	Breakfast with the Host Family Lessons Lunch at the Centre Arts and Crafts Dinner + Evening with the Host Family
Saturday	07.30 - 08.00 08.30 - 19.00 Evening	Breakfast with the Host Family Full Day Excursion to London including a visit to the London Eye (Packed lunch provided by the Host Family) Dinner + Evening with the Host Family
Sunday	With the Host Family	
On Course C-1.20 English language lessons and sports/leisure activities may alternate between mornings and afternoons on a weekly basis.		

Subject to change

Young Learners and Teenagers Courses C-2.20 June, July and August		
Monday	07.30 - 08.00 08.45 - 12.15 12.15 - 13.15 13.15 - 16.30 Evening	Breakfast with the Host Family Lessons Lunch at the Centre Mini Golf or the Beach Dinner + Evening with the Host Family
Tuesday	07.30 - 08.00 08.45 - 12.15 12.15 - 13.15 13.15 - 16.30 Evening	Breakfast with the Host Family Lessons Lunch at the Centre Movie Making Dinner at the Centre Talent Show
Wednesday	07.30 - 08.00 08.45 - 12.15 12.15 - 13.15 13.15 - 16.30 Evening	Breakfast with the Host Family Lessons Lunch at the Centre Half Day Excursion to Hengistbury Head Adventure Activity Centre Dinner + Evening with the Host Family
Thursday	07.30 - 08.00 08.45 - 12.15 12.15 - 13.15 13.15 - 16.30 Evening	Breakfast with the Host Family Lessons Lunch at the Centre Team Challenges Dinner at the Centre Themed Disco
Friday	07.30 - 08.00 08.45 - 12.15 12.15 - 13.15 13.15 - 16.30 Evening	Breakfast with the Host Family Lessons Lunch at the Centre Sports at Meyrick Park Dinner + Evening with the Host Family
Saturday	07.30 - 08.00 08.30 - 19.00 Evening	Breakfast with the Host Family Full Day Excursion to London including a walking tour, Thames Boat Trip and Tower of London (Packed lunch provided by the Host Family) Dinner + Evening with the Host Family
Sunday	With the Host Family	
On Course C-2.20 English language lessons and sports/leisure activities may alternate between mornings and afternoons on a weekly basis.		

Subject to change



Intensive Teenagers Course C-3.30 June, July and August

Monday 07.30 - 08.00 Breakfast with the Host Family
 08.45 - 12.15 Lessons
 12.15 - 13.15 Lunch at the Centre
 13.15 - 16.30 Lessons + Educational Activities
 Evening Dinner + Evening with the Host Family

Tuesday 07.30 - 08.00 Breakfast with the Host Family
 08.45 - 12.15 Lessons
 12.15 - 13.15 Lunch at the Centre
 13.15 - 16.30 Lessons + Educational Activities
 Evening Dinner at the Centre
 Wacky Races

Wednesday 07.30 - 08.00 Breakfast with the Host Family
 08.45 - 12.15 Lessons
 12.15 - 13.15 Lunch at the Centre
 13.15 - 16.30 Half Day Excursion to Rock Reef
 Adventure Activity Centre
 Evening Dinner + Evening with the Host Family

Thursday 07.30 - 08.00 Breakfast with the Host Family
 08.45 - 12.15 Lessons
 12.15 - 13.15 Lunch at the Centre
 13.15 - 16.30 Lessons + Educational Activities
 Evening Dinner at the Centre
 Summer Ball

Friday 07.30 - 08.00 Breakfast with the Host Family
 08.45 - 12.15 Lessons
 12.15 - 13.15 Lunch at the Centre
 13.15 - 16.30 Lessons + Educational Activities
 Evening Dinner + Evening with the Host Family

Saturday 07.30 - 08.00 Breakfast with the Host Family
 08.30 - 19.00 Full Day Excursion to Harry Potter
 Studio Tours London (Packed lunch
 provided by the Host Family)
 Evening Dinner + Evening with the Host Family

Sunday With the Host Family

On Course C-3.30 English language lessons may alternate between mornings and afternoons on a weekly basis.

Subject to change





Vacation Programme

The Vacation Course consists of 20 lessons per week of General English language lessons.

Classes

Your son/daughter will study in a lively international atmosphere with others whose levels of English are similar. Your son/daughter will be taught by a team of two or three teachers, who encourage participation and interaction between members of the group - and English will be the only language used!

Lessons

Your son/daughter will receive a balanced programme which includes grammar, skills development, and vocabulary development. The classes will be learner-centred. This means that students will take an active part in the classes and will be expected to speak with and listen to fellow students in pairs or small groups.

Homework

Homework forms an integral part of the course.

Progress

Lessons will include a variety of activities including games, quizzes, pair and group work, which will enable the teacher to assess your son/daughter's performance on a weekly basis. If your son/daughter's class reaches the end of a level, a longer test will be given to see if your son/daughter is ready to progress onto the next level.

Excursions, Sports and Leisure Activities

A wide variety of excursions, sports and leisure activities are an integral part of the programme. Students develop their language during activities and excursions using quizzes and worksheets about the destination or activity. Excursions and activities are also followed up in class and students are encouraged to develop language through their experiences.



Vacation Programme

Vacation Course 2019

Course number	V-1.20
Course type	Vacation Course
Lessons per week <small>(lesson duration: 45 minutes)</small>	20
Language levels	Beginner* to Advanced
CEFR levels	A1* - C1
Class size	Average 13 (max.15)
Age group	16 - 20
Course duration (weeks)	2 - 5
Full day excursion	1 per week
Daytime leisure activities	5 per week
Arrival and departure transfers	At extra cost see pages 24 - 25
Courses held between	7 January - 9 February
Course fees	Pounds sterling
First 2 weeks	815
Each additional week	335
Homestay accommodation fees - twin room	Pounds sterling
First 2 weeks	462
Each additional week	201
Single room supplement	30 per week

Course fees include...

- Enrolment fee
- Entry test
- Tuition
- Textbooks and teaching materials
- Student card
- Certificate of Studies
- Orientation tour on the first day
- Wi-Fi
- Sports and leisure activities
- Excursions (including entrance fees)

Accommodation fees include...

- Twin room from the Sunday before course commencement to the Sunday after its completion
- Light laundry service
- Wi-Fi
- Limited availability of twin rooms for 18 - 20 year olds. Where a twin room is unavailable, an upgrade will be made to a single room.

Meals

- Lunch from Monday to Friday is taken at the centre. The homestay family will provide a packed lunch for the excursion on Saturday. All other meals are taken with the homestay family.
- Students who do not have homestay accommodation are required to pay £ 35 per week for lunches Monday to Friday.
- Please advise us at the time of booking if your son/daughter wishes to make his/her own lunch arrangements Monday - Friday and we will deduct £ 35 per week from the accommodation fee.

Please note

- English language lessons and sports/leisure activities may alternate between mornings and afternoons on a weekly basis
- Lessons may be integrated with the General English Course G-1.20.

Course entry dates 2019

V-1.20

January
7*, 14,
21, 28

* Beginners may start their courses only on the entry dates marked with asterisks (*)

"It's a kind place with lots of different people from all around the world. I feel more comfortable speaking English now."

Carmen, Spain

June
July
August

Vacation Programme

Vacation Course 2019

Course number	V-2.20
Course type	Vacation Course
Lessons per week (lesson duration: 45 minutes)	20
Language levels	Beginner* to Advanced
CEFR levels	A1* - C1
Class size	Average 13 (max.15)
Age group	16 - 20
Course duration (weeks)	2 - 12
Full day excursion	1 per week
Daytime leisure activities	5 per week
Evening leisure activities	2 per week
Arrival and departure transfers	At extra cost see pages 24 - 25
Courses held between	3 June - 24 August
Course fees	Pounds sterling
First 2 weeks	815
Each additional week	335
Homestay accommodation fees - twin room	Pounds sterling
First 2 weeks	462
Each additional week	201
Single room supplement	30 per week

Course fees include...

- Enrolment fee
- Entry test
- Tuition
- Textbooks and teaching materials
- Student card
- Certificate of Studies
- Orientation tour on the first day
- Wi-Fi
- Sports and leisure activities
- Excursions (including entrance fees)

Accommodation fees include...

- Twin room from the Sunday before course commencement to the Sunday after its completion
- Light laundry service
- Wi-Fi
- Limited availability of twin rooms for 18 - 20 year olds. Where a twin room is unavailable, an upgrade will be made to a single room.

Meals

- Lunch from Monday to Friday is taken at the centre. The homestay family will provide a packed lunch for the excursion on Saturday. All other meals are taken with the homestay family.
- Students who do not have homestay accommodation are required to pay £ 35 per week for lunches Monday to Friday.
- Please advise us at the time of booking if your son/daughter wishes to make his/her own lunch arrangements Monday - Friday and we will deduct £ 35 per week from the accommodation fee.

Please note

- English language lessons and sports/leisure activities may alternate between mornings and afternoons on a weekly basis
- Lessons may be integrated with the General English Course G-1.20.

Course entry dates 2019 V-2.20

June 3, 10, 17*, 24	July 1, 8*, 15, 22, 29*	August 5, 12
---------------------------	-------------------------------	-----------------

* Beginners may start their courses only on the entry dates marked with asterisks (*)

"Bournemouth is such an amazing town. There's everything you need. You can go shopping, to the beach or at the park, meet your friends. I love it, because it's full of people and students from different nationalities and cultures!"

Olimpia, Italy

All entrance fees are included in the course fees



The New Forest National Park

Typical full-day excursions selected from:

- London tours by coach including sightseeing. These excursions may also include:
 - visit to the London Eye
 - visit to Covent Garden
 - River Thames boat cruise
 - visit to Trafalgar Square and the National Gallery
 - visit to the Natural History/Science Museum and Harrods
- Harry Potter Studio Tour near London
- The City of Bath - visit to the Roman Baths
- The University City of Oxford - visit to Christ Church College, the Natural History Museum and time for shopping
- Bristol - Brunel's ss Great Britain ship and Bristol City Museum
- Salisbury and Stonehenge
- The Roman City of Bath and Wookey Hole Caves and Papermill
- Kingston Lacy - 17th Century House/Gardens and Lulworth Cove
- Winchester, Beaulieu and the New Forest National Park
- The New Forest National Park to include the waterside town of Lymington and Breamore House

The full-day excursions, included in the fees, take place on Saturdays. On Sundays, full-day excursions and on weekdays half-day excursions are organised to interesting destinations at extra cost.



The London Eye

Typical sports and leisure activities selected from:

- Walking tour of Bournemouth
- Bournemouth Oceanarium
- New age kurling
- Cinema
- Ten-pin bowling
- Anglo casino
- Arts and crafts
- Beach games
- Basketball
- Badminton
- Boat trip
- Board games
- Team challenges
- Table tennis
- Roller disco
- Swimming
- Anglo olympics
- Photography challenge
- Digital scavenger hunt
- Ceramic art workshop
- Karaoke
- Shopping trip
- Ice skating
- Laser quest
- Football
- Movie making
- Treasure hunt
- Talent show
- Volleyball
- Quizzes
- Dance workshop
- Drama
- Mini golf





Typical Timetables

The detailed excursion and activity programmes are available 6 months before course commencement: www.anglo-continental.com/vacation.html



Vacation Course V-1.20 January and February

Monday	07.30 - 08.00 08.45 - 12.15 12.15 - 13.30 13.30 - 16.30 Evening	Breakfast with the Host Family Lessons Lunch provided at the Centre Bournemouth Walking Tour or Anglo Cinema and Movie Quiz Dinner with the Host Family
Tuesday	07.30 - 08.00 08.45 - 12.15 12.15 - 13.30 13.30 - 16.30 Evening	Breakfast with the Host Family Lessons Lunch provided at the Centre Bournemouth Oceanarium Dinner with the Host Family
Wednesday	07.30 - 08.00 08.45 - 12.15 12.15 - 13.30 13.30 - 16.30 Evening	Breakfast with the Host Family Lessons Lunch provided at the Centre Arts and Crafts Dinner with the Host Family
Thursday	07.30 - 08.00 08.45 - 12.15 12.15 - 13.30 13.30 - 16.30 Evening	Breakfast with the Host Family Lessons Lunch provided at the Centre Team Challenges Dinner with the Host Family
Friday	07.30 - 08.00 08.45 - 12.15 12.15 - 13.30 13.30 - 16.30 Evening	Breakfast with the Host Family Lessons Lunch provided at the Centre Drama Workshop Dinner with the Host Family
Saturday	07.00 - 07.30 08.00 - 19.00 Evening	Breakfast with the Host Family Full Day Excursion to London including a River Thames boat cruise and visit to the National Maritime Museum and Royal Observatory in Greenwich (Packed lunch provided by the Host Family) Dinner with the Host Family
Sunday	Optional Excursion available at extra cost.	

On Course V-1.20 English language lessons and sports/leisure activities normally alternate between mornings and afternoons on a weekly basis.

Subject to change



Vacation Course V-2.20 June, July and August

Monday 07.30 - 08.00 Breakfast with the Host Family
08.45 - 12.15 Lessons
12.15 - 13.30 Lunch provided at the Centre
13.30 - 16.30 Bournemouth Walking Tour or Anglo Cinema and Movies Quiz
Evening Dinner with the Host Family

Tuesday 07.30 - 08.00 Breakfast with the Host Family
08.45 - 12.15 Lessons
12.15 - 13.30 Lunch provided at the Centre
13.30 - 16.30 Boat Trip
Evening Dinner with the Host Family

Wednesday 07.30 - 08.00 Breakfast with the Host Family
08.45 - 12.15 Lessons
12.15 - 13.30 Lunch provided at the Centre
13.30 - 16.30 Photography Challenge
Evening Dinner with the Host Family
19.00 - 21.00 Anglo Cinema

Thursday 07.30 - 08.00 Breakfast with the Host Family
08.45 - 12.15 Lessons
12.15 - 13.30 Lunch provided at the Centre
13.30 - 16.30 Team Challenges
Evening Dinner with the Host Family

Friday 07.30 - 08.00 Breakfast with the Host Family
08.45 - 12.15 Lessons
12.15 - 13.30 Lunch provided at the Centre
13.30 - 16.30 Sports at Meyrick Park
Evening Dinner with the Host Family
19.00 - 21.00 Quiz Night

Saturday 07.00 - 07.30 Breakfast with the Host Family
08.00 - 19.00 Full Day Excursion to London including a visit to Trafalgar Square and the National Gallery (Packed lunch provided by the Host Family)
Evening Dinner with the Host Family

Sunday Optional Excursion available at extra cost.

On Course V-2.20 English language lessons and sports/leisure activities normally alternate between mornings and afternoons on a weekly basis.



Subject to change



Accommodation

Selection of homestay accommodation

Carefully selected homestay accommodation is an established feature of all our programmes. Thanks to our selection process, administration and supervision of our homestay accommodation, we ensure that your son/daughter is comfortable and well looked after during his/her course. All homestay accommodation registered with Anglo-Continental is checked at regular intervals by our staff and evaluated by our students, to ensure that it remains at a high standard.

Why stay in homestay accommodation?

- Your homestay family will make your son/daughter feel welcome and will help him/her with any concerns during his/her stay.
- Your son/daughters language and cultural experience in England will be enhanced by living with a host family.
- Your son/daughter will be treated like a member of the family.
- The homestay family will make time to speak with your son/daughter at meal times and will invite your son/daughter for a chat during free time. This is a great way to advance your son/daughter's English outside of the classroom.

- The homestay family will also help your son/daughter with practical matters such as how to get to school on the first day.

Homestay accommodation includes:

- A pleasantly furnished twin bedroom.
- Limited availability of twin rooms for 18 - 20 year olds. Where a twin room is unavailable, an upgrade will be made to a single room.
- Shared shower or bathroom and toilet facilities.
- Lunch from Monday to Friday is taken at the school. All other meals are taken with the homestay family.
- Students on Young Learner Courses C-2.20 and C-3.30 will take two evening meals at the school.
- Bed linen and towels are provided weekly.
- A supply of duvets and blankets are available.
- A light laundry service (one load per week).
- Wi-Fi.

Important notice - students under 18 years

In accordance with British Council recommendations, we check that homestay family members are suitable to accommodate students under 18 years of age by using the Disclosure and Barring Service (DBS).



"We have been hosting students with Anglo-Continental for a number of years now. We play cards, sing songs (the 'cup song' was a firm favourite this year), work on jigsaw puzzles and even bake brownies together. We love it!"

Mrs Boyle, Homestay Family

Safety and student support



The safety and wellbeing of our students is one of our top priorities. Anglo-Continental has fully trained staff and facilities to provide a high standard of student support, safety and first aid.

Help on the first day

- The host family will help your child to get to school.
- Your child will watch a safety film on how to stay safe in the UK.
- Your child will be given a Student Card with emergency contact information.
- The school will take a photograph of your child for identification purposes.
- Staff will ensure that your child gets safely home, whether this is by door-to-door car service, walking with a map provided by the school or accompanying your child to the bus stop if necessary.

Safety features

- Experienced, caring and approachable staff.
- British Council approved staff to student ratios of a high level of supervision.
- 24 hour supervision for students aged 13 and under.
- Door-to-door private car service. All drivers are checked with the Disclosure and Barring Service (DBS).

- The Young Learner/Teenager Courses are run in a secure building with special dedicated facilities solely used for the younger age groups.
- Students under 18 years of age are strictly monitored. Any unauthorised absence is followed up by our staff.
- Private fostering families provide extra support for long-term students under the age of 16.
- Fully qualified and experienced First aid staff. A dedicated first aid room.

Counselling service

When your son/daughter is away from home, problems can arise. Most of these are easily solved with the help of our Student Services staff.

Our trained Student Support staff provide a confidential and discreet service for problems of a delicate or sensitive nature. Two members of the Student Support Team are fully qualified therapeutic counsellors and members of the British Association of Counselling and Psychotherapy (BACP). As well as qualifications, the Student Support Team has a wealth of experience in dealing with international students and the variety of problems that might arise.

"We have been hosting young learners for over 6 years now. We have two children age 10 and 15 and it is a wonderful experience for the whole family to learn about different cultures and languages. We love having the students and they all seem to enjoy staying with us."
Mrs Dyer, Homestay Family



Anglo-Continental transfer services

Recommended Option



Anglo-Continental's coach transfer services

On Arrival

- meet and greet at London Heathrow
- escorted transfer to school
- car to accommodation

On Departure

- car from accommodation to school
- escorted transfer to London Heathrow

Reservation and confirmation of flight details are required no later than 10 days in advance.

Anglo-Continental Coach Transfer Services

Journey time: Approximately 2 hours

London Heathrow Airport (LHR) to Accommodation

Sunday 2, 9, 16, 23, 30 June 2019
 Sunday 7, 14, 21, 28 July 2019
 Sunday 4, 11 August 2019

Accommodation to London Heathrow Airport (LHR)

Sunday 16, 23, 30 June 2019
 Sunday 7, 14, 21, 28 July 2019
 Sunday 4, 11, 18, 25 August 2019

Coaches depart between

0800 to 2000 hours

Charges per person

£ 46

Coaches depart between

0500 to 1600 hours

£ 46

If your son/daughter is under 16 years of age and travelling without an adult we will ensure that a member of our team will take your child to the check-in counter and check him/her onto the flight and accompany him/her to security. If you have pre-arranged Unaccompanied Minor services with the airline, our team member will hand your son/daughter over to the airline representative. £ 40



Anglo-Continental Car Transfer Services

offer a personal meet and greet service from any location in Great Britain at any time and on any day. Your son/daughter will be driven directly and comfortably to the destination.

A second passenger may travel in the same car for a surcharge of £ 16.

Your son/daughter may be sharing a car with another student.

Reservation and confirmation of flight details are required no later than 10 days in advance.

Anglo-Continental Car Transfer Services Charges per single journey

From/To	Time	1 person	Extra Waiting*
London Heathrow	Any time	£ 163	£ 20
London Gatwick	Any time	£ 178	£ 20
London City	Any time	£ 294	£ 20
London Centre	Any time	£ 240	£ 20
London Stansted	Any time	£ 228	£ 20
London Luton	Any time	£ 278	£ 20
Southampton Airport	Any time	£ 89	£ 20
Bournemouth Airport	Any time	£ 52	£ 20

If your son/daughter is under 16 years of age and travelling without an adult we will ensure that a member of our team will take your child to the check-in counter and check him/her onto the flight and accompany him/her to security. If you have pre-arranged Unaccompanied Minor services with the airline, our team member will hand your son/daughter over to the airline representative. £ 40

* The first 2 hours of waiting time are free of charge. Extra waiting time charge per 30 minutes.

Arrival in England

Travel information

The flight/travel details and time and place of arrival must be provided no later than 10 working days before the Sunday of course commencement, and reconfirmed to us in the event of any change. For this purpose, we require you to complete and return the Declaration form on pages 29 and 30.

Reception at the airport

All students who have reserved Anglo-Continental transfers, and for whom travel details have been received, are met by our staff in the 'Arrivals Area'. Full details of the meeting point are given in the confirmation documents.

To identify our staff, your son/daughter should look for the sign:



Help telephone numbers

If your son/daughter does not arrive on the flight specified, or is delayed and therefore fails to meet our staff, he/she should call the emergency telephone number given on the school confirmation documents.

Delayed arrival - car transfers

The driver will wait for 2 hours from the advised arrival time. If your son/daughter is delayed,

for whatever reason, the driver will wait for up to an additional 2 hours and your son/daughter will be charged £ 20 per 30 minutes on the first day of school.

Possible waiting times for coach transfers

It is our aim to transfer your son/daughter to Bournemouth as soon as possible after meeting our representative. However, Anglo-Continental cannot be held responsible for delays caused by late arrival of incoming flights, congestion at UK Border Control, hold ups at Customs, heavy traffic on the roads or any other event.

Departure from England

Return flights

Our staff will confirm the travel arrangements for the return journey, and revalidation if required. If the ticket has to be changed for any reason, an administrative charge will be added for this service. You will be responsible for paying any additional charges imposed by the transport company.

Escorted transfers to the airport on departure

If you have reserved a return transfer to London Heathrow Airport (LHR) on the Sunday at the end of the course, for flights departing between 10.00 and 20.00 hours, our staff will escort your son/daughter to the airport. If you have requested the check-in service, your son/daughter will be escorted to the check-in and handed over to a member of the airline staff.

Anglo-Continental Transfer Condition

Luggage allowance - car and coach transfers

Your son/daughter's free allowance is one piece of luggage of a standard size and shape weighing not more than 23kg, plus one item of hand luggage of not more than 10kg.

If your son/daughter's luggage does not conform with the above, an additional charge may have to be made. It is important that you advise us in advance if there is excess baggage so we can make appropriate arrangements, otherwise you may find that the excess luggage cannot travel with your son/daughter and there may be additional charges.

Young Learners travelling alone

If your son/daughter is under 16 years of age and is travelling without an adult, the transfer service and check-in service will automatically be reserved and invoiced. We advise you to check with the airline for rules and regulations regarding this. You will be responsible for any unaccompanied child airline service charges. A member of our team will take your child to the check-in counter and check him/her onto the flight and accompany him/her to security.

Payment

Payment for transfers must be made before the date of provision of the service. Any additional charges, such as delayed arrival, must be paid on the first day of school.

Cancellation

Notice of cancellation or change of a transfer must be received in writing by the school before 12.00 hours (British Time) on the Wednesday prior to the scheduled day of arrival or departure. If such notice is not received within the period stipulated, we incur obligations to the transport companies and therefore the full charge is due.

Liability and insurance

We cannot accept responsibility for any delay in scheduled services, or if any service cannot be provided as specified, or for any loss, damage or injury to students or their property during travel. We strongly advise you to take out personal insurance to cover your son/daughter against these risks.

Fuel surcharge

If a transportation company levies a surcharge because of an increase in the price of fuel, the additional cost will be charged to you. Please check the website for the latest charges www.anglo-continental.com/more-info/transfer-services



Public transfer services (Vacation Students only)

National Express Coaches



National Express Coaches

National Express provide bus services to the public. There are frequent services throughout the day every day of the year and services from London Heathrow are direct to the Bournemouth Interchange. However,

if your son/daughter arrives at another airport, he/she will have to change buses. Your son/daughter will need to take a taxi from the coach station to his/her accommodation. For full details of National Express Coach services, current timetables and prices please visit www.nationalexpress.com as coach times may vary.

National Express Coaches to Bournemouth

Coach Station

London Heathrow Airport
London Gatwick Airport
London City Airport
London Stansted Airport
London Luton Airport

Coaches operate between

07.30 - 23.00
06.30 - 24.00
06.10 - 24.00
06.20 - 23.55
06.00 - 23.55

Trains



National Rail

Train services from London Waterloo and Southampton Airport Parkway are direct and available every day of the year. Other airports are served by trains but are not direct and may involve

a coach or the underground depending on the particular airport. Your son/daughter will need to take a taxi from Bournemouth railway station to his/her accommodation. For full details of National Rail services, current timetables and prices please visit www.nationalrail.co.uk as train times may vary.

National Rail Services to Bournemouth

Train Station

London Heathrow Airport
London Gatwick Airport
London City Airport
London Stansted Airport
London Luton Airport

Trains operate between

06.45 - 23.35
06.50 - 22.30
06.00 - 23.10
05.30 - 23.15
06.20 - 23.00

Conditions of enrolment 2019

Enrolment

All enrolments are subject to these conditions, which become legally binding on confirmation of acceptance by Anglo-Continental, and to the age limitations and arrangements specified in Anglo-Continental's official publications, including the 'Student Handbook'.

The enrolled student intends and is able to follow and complete the course of study at Anglo-Continental and declares that he/she shall abide by all current UK laws and leave the United Kingdom at the end of his/her studies.

Anglo-Continental reserves the right to withhold confirmation of an enrolment, at its discretion, if such action is deemed necessary in the interests of the student or the school or if an incorrect declaration has been made.

Fees

The fees must be received in full by Anglo-Continental no later than four weeks before course commencement, otherwise Anglo-Continental reserves the right to cancel, without notice, the course, accommodation and all other services. Course fees are calculated in complete weeks, and any part of a week is counted as a full week.

No compensation, fee reductions, refunds, credit, additional lessons or extension of the course can be given for:

- services or facilities included in the fees and not used;
- late entry to or absence or early departure from a course;
- lessons replaced by testing, class allocation procedures or the sightseeing tour on course entry dates;
- days when schools are closed because of official holidays.

Any refunds which are approved can only be made by the office or Agent to whom the fees were originally paid. Anglo-Continental reserves the right to make fee adjustments as a result of changes to statutory taxes without prior notice.

Visas

If your son/daughter requires a visa, **it is your responsibility to ensure that your son/daughter applies for the correct type of visa** to allow your son/daughter to study at Anglo-Continental for the entire period of the course(s). It is also your responsibility to ensure that your son/daughter continues to maintain the correct immigration status to study at Anglo-Continental for the duration of the course(s). Failure to do so may lead to termination of your son/daughter's studies without refund or compensation. For further information regarding UK visa requirements see page 31.

School regulations

School regulations are designed to ensure that the courses function smoothly. Acceptance of and compliance with these regulations, and with English law, are contractual obligations on the part of the parent, guardian or other person arranging the student's enrolment with Anglo-Continental. The school regulations are available online: www.anglo-continental.com/schoolregs-yl.html

It is essential that your son/daughter understands that he/she must accept the regulations concerning 'Conduct and Discipline' and 'Permission to go out Without Supervision' as agreed by the Parent/Guardian.

Failure to observe the requirements of conduct described here and in the 'Student Handbook' may result in the student being returned home before the end of the course, without compensation. Anglo-Continental reserves the right to alter the student's travel arrangements.

It is the responsibility of the parent/guardian to arrange for an adult to meet the student at the place of arrival and at a time specified by Anglo-Continental.

Cancellation or postponement of a course

A course is not transferable but may be cancelled or postponed and full course fees will be refunded (except for bank charges), provided that written notice is received by Anglo-Continental not less than four weeks before the scheduled date of course commencement. In the absence of such notice, or if less than four weeks notice is received:

- in the case of cancellation, a fee of £ 500 is payable in lieu of notice;
- in the case of postponement, Anglo-Continental reserves the right to levy a charge to cover administration and accommodation costs incurred on the student's behalf;
- should the application for a visa be refused, we will refund any published fees paid in advance (after deduction of an administration charge of £ 100) provided that you send us a copy of the letter of refusal before the intended start date of the course.

Any additional charges for services provided by a third party (such as Home Office CAS charges and courier services) are not refundable.

Curtailed of a course

If a course is curtailed after commencement, no refund can be given. Parents or guardians must arrange insurance against inability to attend or continue a course for medical or compassionate reasons (see 'liability and insurance').

Incorrect declaration

Anglo-Continental reserve the right to withdraw a student from the course if an incorrect declaration has been made or if information regarding a student's ability to participate in the course has not been disclosed to us before course commencement. In this case, no refund can be made.

Accommodation

The fee for the first week in accommodation includes a non-refundable administration charge to cover the cost of selection, reservation and administration.

Any request to change or leave homestay accommodation must be made to Anglo-Continental at least two weeks before the date of the proposed move, and approved before the change is made. Failing this, accommodation fees are payable in lieu of notice.

Accommodation fees continue to be payable for any periods of absence during the course.

It is essential that your son/daughter understands that:

- a) he/she will be sharing accommodation with other students and must observe the accepted standards of courtesy and consideration towards others;
- b) he/she will be expected to make his/her own bed, help to keep the room tidy and leave bathrooms and toilets clean for other users;
- c) he/she must observe the bedtimes stated by the homestay family - normally not later than 22.30 hours.

Supervised door-to-door car service

The supervised door-to-door car service is compulsory for students aged 10 - 13 years and is included in the accommodation fees. This service is not available for students aged 16 or over on the Vacation Programme.

Anglo-Continental car transfer services

Your son/daughter is allowed two hours' waiting time from the advised arrival time, free of charge. If this time is exceeded, a further two hours waiting time will be charged in accordance with the published tariff.

Photography, film, sound recordings and written work

During our courses we sometimes take photographs, film footage and sound recordings, some of which may be incorporated into items such as, but not limited to, future publicity material, social media sites, tests and educational materials. We may also wish to use examples of your son/daughter's written work. If you do not wish your son/daughter to participate in any of these items, please advise Anglo-Continental in writing before the start of the course.

Liability and insurance

Anglo-Continental will not be liable for any loss, damage, illness or injury to persons or property however caused, except where such liability is imposed by statute. Anglo-Continental will also not be held responsible for any delay in scheduled services of third party companies, or if any service cannot be provided as specified. Any complaints, liabilities, losses or damages arising should be submitted to the third party company concerned. It is the parent's or guardian's responsibility to take out personal insurance against all such risks, including inability to attend or continue a course and for the payment of medical expenses.

Young Learners Declaration Form

Anglo-Continental must receive a completed Young Learners Declaration Form before your son/daughter commences his/her course. This form provides essential emergency contact information. In the absence of this form, if an emergency situation arises, Anglo-Continental will make the best judgement on any action which needs to be taken based on professional advice available at the time of the emergency.

Force majeure

It shall be a fundamental condition of the contract between the parent/guardian and Anglo-Continental or its Agents that neither Anglo-Continental nor its Agents shall be in any way liable to the student, parents or guardians in the event of any service contracted to be supplied by them becoming impossible to supply by reason of industrial dispute or other cause outside their control.

Data protection

To ensure that the course at Anglo-Continental meets your requirements we and, if appropriate, the Anglo-Continental Agent in your own country will need to use the information you provide (such as your son/daughter's personal data and details of any special requirements) in order to process the enrolment.

We must pass this information on to those involved in providing your son/daughter with services relating to his/her stay at Anglo-Continental, such as the reservation of accommodation and transfer services.

The information may also be provided, if required, to security or credit-checking organisations, customs and the Home Office as required by English law.

Please note that where your son/daughter's information is held by an Anglo-Continental Agent, it will be subject to your Agent's own data protection policy and your country's national law.

Validity of conditions

These Conditions of enrolment are valid from 1 January 2019 and are subject to English law. The English language version is legally binding in all cases.

Anglo-Continental reserves the right to waive or adjust the specifications of a course, which may include age limits, without prior notification.

Enrolment form 2019



Detach here

Personal data of student

(Please complete in BLOCK CAPITALS)

Male Female

Please mark

Student's family name

First name

Date of birth

Place and country of birth

Nationality

Mother tongue

Passport number (if a visa is required)

As in passport

Home address of parent or guardian

Mr Mrs Miss Other

Name of parent/guardian

Road/Number

Town/Postcode

Country

Mailing address (if different from home address)

Name

Road/Number

Town/Postcode

Country

Contact details

Telephone - private

Telephone - business

Telephone - mobile

Email

Skype

Has your son/daughter attended an Anglo-Continental course before? Yes No

If yes, in which year(s):

What is your son/daughter's present level of English?

Beginner Intermediate
Elementary Upper intermediate
Pre-intermediate Advanced

Course data

Day / Month / Year
Preferred entry date / / Number of weeks

International student travel insurance

I wish to book insurance for the duration of my son/daughter's course

My son/daughter will attend the following course:

Young Learners Course C-1.20 Age group 10 - 16

Young Learners Course C-2.20 Age group 10 - 16

Intensive Teenagers Course C-3.30 Age group 14 - 16

I require door-to-door transport (compulsory for 10 - 13 year olds)

Vacation Course V-1.20 Age group 16 - 20

Vacation Course V-2.20 Age group 16 - 20

I do not wish to receive pre-paid meal vouchers for lunch, from Monday to Friday, at the school.

Accommodation data

My son/daughter requires accommodation as specified for the course (Sunday to Sunday).

Vacation Courses only - My son/daughter requires a single room at additional cost (limited availability)

My son/daughter does not require accommodation. I shall be making my own arrangements, and will provide details of the accommodation address. A supplement for meals will be included on the invoice.

Does your son/daughter suffer from any allergy, dietary condition or take any medication of which we should be aware? Yes No

If yes, please give details

Does your son/daughter have any special dietary requirements? e.g. vegetarian, vegan, coeliac, gluten free, lactose free or serious nut allergy Yes No

If yes, please give details

Special diets, except for a vegetarian diet, will incur an extra charge of £25 per week and are subject to availability.

Does your son/daughter have a physical disability, learning disability or mental health issue? Yes No

If yes, please give details

Young Learners complete the declaration on pages 29 and 30.

Arrival and departure transfer services (Please refer to pages 24 + 25)

I wish to reserve:

Anglo-Continental escorted coach transfer On arrival
(Operates every Sunday from 02 June to 11 August from London Heathrow Airport to Bournemouth, and from 16 June to 25 August from Bournemouth to London Heathrow Airport) On departure

Reception and transfer by car On arrival
(Operates daily from any point of arrival/departure) On departure

Airport/place of arrival

Airport/place of departure

If you reserve a transfer, you must advise Anglo-Continental of the travel details not less than 10 days before arrival.

Signature

I confirm that I have read and accept the Conditions of enrolment on page 26, and have completed the 'Payment of fees' on page 28.

I also confirm that after receipt, I shall read the 'Student Handbook' and explain the regulations concerning 'conduct and discipline' and 'permission to go out without supervision' to my son/daughter.

Young Learners' only - I will return the declaration form on pages 29 and 30 to reach Anglo-Continental not less than 10 days before my son/daughter's arrival.

Signature of parent/guardian (If student is under 18 years of age)

I consent to the processing of my personal data in accordance with the Privacy Policy, and would like to receive the latest news, offers and information from Anglo-Continental

X _____

Date

Detach here

Payment of fees



Detach here

Please repeat the student's name as it appears on the 'Enrolment form' overleaf

First name

Family name

Where to pay the fees

- I will pay the fees to Anglo-Continental (Please complete the relevant section in 'how to pay the fees')
- I will pay the fees to Anglo-Continental's Agent (In this case please do not complete the 'how to pay the fees' section as our Agents have their own payment procedures)

How to calculate the fees

Course fees	<input type="text"/>	weeks	=	£	<input type="text"/>
Accommodation fees	<input type="text"/>	weeks	=	£	<input type="text"/>
Door-to-door transport	<input type="text"/>	weeks	=	£	<input type="text"/>
Single room supplement	<input type="text"/>	weeks	=	£	<input type="text"/>
International student travel insurance	<input type="text"/>	weeks	=	£	<input type="text"/>
Sub total				£	<input type="text"/>

Transfer charges

	On arrival	On departure	
Anglo-Continental coach transfer	<input type="text"/>	<input type="text"/>	£ <input type="text"/>
Anglo-Continental car transfer	<input type="text"/>	<input type="text"/>	£ <input type="text"/>
Check-in service at the airport (if travelling alone)	<input type="text"/>		£ <input type="text"/>
Total			£ <input type="text"/>

When to pay the fees

If your son/daughter DOES NOT require a VISA

The fees must be received in full at least 4 weeks before course commencement. (No deposit required).

If your son/daughter REQUIRES a VISA

To obtain a visa you will need our confirmation documents. We must therefore ask you for a deposit of £ 500 (deductible when you pay the fees), or the full amount of the fees due, at the time of enrolment.

- I wish to pay the deposit of £ 500 now (deductible when I pay the fees) and I confirm that I will pay the balance to reach Anglo-Continental not later than 4 weeks before course commencement
- I wish to pay the fees in full now

Refund guarantee

Should the application for a visa be refused, we will refund any published fees paid by you (after deduction of an administration charge of £ 100) provided that you send us a copy of the letter of refusal before the intended start date of the course and the refusal was not based on incomplete or inaccurate information on your visa application. Any additional charges for services provided by a third party (such as courier services) are not covered by this guarantee.

How to pay the fees

- Preferred payment method** - I will arrange a secure online bank transfer or credit card payment via Flywire:
<https://www.flywire.com/pay/anglo-continental>



- Bank transfer**
I will arrange for a bank transfer using SWIFT to:
Lloyds Bank plc, 45 Old Christchurch Road
Bournemouth BH1 1ED, England
Account name: Anglo-Continental
Account number: 01 91 75 58
IBAN: GB05 LOYD 3091 0801 9175 58
BIC: LOYDGB21045
Sort code: 30-91-08

(Please inform your bank that you will pay **all** bank transfer charges both in your own country and in England, and send us a copy of the Bank's Transfer Confirmation as proof of payment.)

Please send the 'Enrolment form' to our Agent in your country or, if no address is given, to:

Anglo-Continental

29-35 Wimborne Road, Bournemouth BH2 6NA, England

Telephone (GB code) +1202 55 74 14

Fax (GB code) +1202 55 61 56

Email english@anglo-continental.com

Website www.anglo-continental.com

If you have been advised by our Agents in your country, please write their name, company name and address in the space provided below:

Detach here

Declaration (For Young Learner and Teenager Courses only)



Detach here

Introduction

This declaration for young learner's is also available in German, French, Italian, Spanish and Russian.

The English version is legally binding in all cases.

For your son/daughter's security and well-being, it is essential that this declaration is completed by the parent/guardian.

Please return this important Declaration to Anglo-Continental not less than 10 days before the start date of the course.

Please affix passport photograph here with the student's name clearly written on the reverse.

(Please complete in BLOCK CAPITALS)

Student data

Please mark

Name of student

Date of birth

Course number

Student's mobile number

Student reference number (if known)

Emergency contact details (if different from Enrolment form)

In case of emergency you can contact:

Name of parent/guardian

Telephone

Mobile number

Email

Name of Agent (if appropriate)

Telephone

Email

Parents arranging private accommodation

I shall be making my son/daughter's accommodation arrangements. I understand that the Anglo-Continental School for Young Learners will not be responsible for my son/daughter's safety and conduct when not involved in activities supervised by Anglo-Continental staff, and that I will be responsible for the arrangements for his/her daily journeys to and from the Centre. I understand that my son/daughter should be collected from the Centre by 16.30 hours on Mondays, Wednesdays and Fridays. Dinner and evening activities are held at the centre on Tuesdays and Thursdays. Therefore my son/daughter shall be collected from the Centre at 20.00 hours on these days.

Signature of parent/guardian

Accommodation arrangements have been made with:

Name

Address

Telephone

Mobile number

Detach here

Medical/dietary information

In the event of serious accident or illness, the school will inform you immediately, and for this purpose it is essential that you notify the school of your emergency contact details during the period of your son/daughter's course as requested.

Please advise us if your son/daughter suffers from any illness, physical or learning disability, allergy or dietary problems, or if he/she has any special dietary requirements or needs to take medication regularly. If regular medication is necessary, please ensure that your son/daughter brings adequate supplies and a legible prescription, in English, from his/her doctor.

To avoid the risk of loss, medicines should be carried in hand-baggage, and not in luggage which is checked in for the flight. On arrival in Bournemouth, students must advise the Head of Centre and Homestay Family of all medicines or prescriptions they have brought with them.

Does your son/daughter suffer from any chronic or recurrent illness, allergy or dietary problem?

Yes No

Does your son/daughter have to take any medication regularly?

Yes No

Is your son/daughter incapacitated in any way?

Yes No

Are there any restrictions on your son/daughter's fitness to take part in sports activities?

Yes No

Does your son/daughter have any special dietary requirements? e.g. vegetarian, vegan, coeliac, gluten free, lactose free or serious nut allergy.

Yes No

If you answer yes to any of the questions, please give full details.

Sickness or accident

In the event of a serious accident or illness, the authority of the parent/guardian is required before emergency medical, surgical or dental treatment can be carried out. In case such permission cannot, for any reason, be obtained in the event of an emergency, as a precaution we strongly recommend that this authority is given to Anglo-Continental in advance on this declaration form to avoid any delay in arranging emergency treatment.

I hereby authorise the senior staff of the Anglo-Continental School for Young Learners to arrange emergency medical, surgical or dental treatment if necessary.

Signature of parent/guardian

Place

Date

Travel details by air

Please attach a copy of the ticket and enter the booking reference number in the space below:

Will your son/daughter be travelling unaccompanied by an adult? If yes, the airport check-in service will automatically be supplied and invoiced.

Yes No

Any additional information

Declaration (For Young Learner and Teenager Courses only)



Detach here

Please repeat the student's name as it appears on the declaration overleaf.

Name of student

Transfer arrangements to accommodation on arrival

(See pages 24 and 25)

My son/daughter will use the Airport Reception and Escorted Transfer by **ANGLO-CONTINENTAL COACH** departing from London Heathrow Airport (LHR) to Bournemouth.

This service runs at regular intervals on Sundays between 08.00 and 20.00 hours from 02 June to 11 August 2019.

Date of arrival	Time of arrival
Flight number	Airline
Airport of departure	
Airport of arrival	London Heathrow (LHR)

Alternative transfer - any day, time or place

I wish to reserve a **CAR** transfer to accommodation.

Date of arrival	Time of arrival
Flight number	Airline
Airport or place of departure	
Airport or place of arrival	

Transfer arrangements from accommodation on departure

(see pages 24 and 25)

My son/daughter will use the Airport Reception and Escorted Transfer by **ANGLO-CONTINENTAL COACH** departing from Bournemouth to London Heathrow Airport (LHR).

This service runs at regular intervals on Sundays between 05.00 and 16.00 hours from 16 June to 25 August 2019. My son/daughter will allow 5 hours for travel, check-in and security procedures. I understand that if the flight departs before 10.00 hours or after 20.00 hours, I should reserve an Anglo-Continental car transfer.

I have made the following flight arrangements for my son/daughter's return journey at the end of the course:

Date of departure	Time of departure
Flight number	Airline
Airport of departure	London Heathrow (LHR)
Destination	

Alternative transfer - any day, time or place

I wish the school to arrange a **CAR** transfer.

Date of departure	Time of departure
Flight number	Airline
Airport or place of departure	
Destination	

Permission to go out without supervision

Age Group 14 - 16

Permission to go out without supervision may be requested for students aged 14 - 16.

I understand that it is compulsory for my son/daughter to attend the complete scheduled programme (lessons, excursions and activities). After completion of the programme my son/daughter must return to his/her homestay accommodation for the evening meal. After this my son/daughter may request permission to leave the homestay accommodation unaccompanied. I have explained to my son/daughter that he/she must return to the homestay accommodation not later than 22.00 hours.

Signature of parent/guardian

No permission to go out without supervision

Age Group 10-13

Students under the age of 14 are not permitted to leave the Course Centre/Homestay Accommodation without supervision. I have instructed my son/daughter to this effect.

Signature of parent/guardian

No permission to go out without supervision

Age Group 14-16

Although this age group may ask to go out without supervision, I do not wish my son/daughter to leave the Course Centre/Homestay Accommodation without supervision, and I have instructed my son/daughter to this effect.

Signature of parent/guardian

Permission for a friend, relative or group leader to take out my son/daughter

Age Group 10-16

If there is a possibility that a relative or friend (aged 18 years or over) will wish to take out your son/daughter for a day or a weekend, it is essential that you fill in the name of the person or persons below. Without this written authority, your son/daughter will not be permitted to go out with any person not known to the School's staff or the Homestay Family. In such cases, the person concerned will be asked to prove his/her identity. e.g. with photographic identification such as a passport or ID card.

Mr / Mrs / Miss

Is authorised to take my son/daughter out at weekends or during free time by arrangement with the Head of Centre or Homestay Family, and will be responsible for his/her safety and conduct on these occasions.

Signature of parent/guardian

Changes to permission

Age Group 14-16

If for any reason you wish to alter the original arrangement for your son/daughter to go out without supervision, we must receive a signed letter of authority from you for the change by post, fax or a scan attached to an email. Emails or verbal messages are not acceptable.

Please complete this declaration and send it to Anglo-Continental to arrive no later than 10 days before course commencement. Please keep a copy for your records.

Anglo-Continental

29-35 Wimborne Road, Bournemouth BH2 6NA, England

Telephone (GB code) +(0)1202 55 74 14

Fax (GB code) +(0)1202 55 61 56

Email english@anglo-continental.com

Website www.anglo-continental.com

Detach here

General information

How to enrol

- Choose the course or courses you wish your son/daughter to attend
- Select the entry date and decide how many weeks you wish your son/daughter to study
- Decide if you wish to use a reserved transfer service from the place of arrival in England to Bournemouth (see pages 24 and 25)
- Decide if you wish to take out International Student Travel Insurance with Anglo-Continental or arrange your own insurance for the duration of the course
- Please complete and send the 'Enrolment form' and 'Payment of fees form', to our Agent in your country. Alternatively, post or email it to Anglo-Continental. You can also enrol and make secure credit card payments online at: www.anglo-continental.com/enrolment

Our confirmation

When the 'Enrolment form' is received and accepted by the school, the following documents will be sent to you:

- A letter of confirmation of enrolment
- An invoice for the full amount of the fees due
- The homestay address, if applicable (due to the careful procedure involved in selecting homestay accommodation the address may be sent to you at a later date)
- Our Student Handbook

If your son/daughter requires a visa, we can only send these documents after we have received your deposit of £ 500 (deductible when you pay the fees) or the full amount of the fees due.

Entry to England

When your son/daughter passes through UK Border Control on arrival in England, he/she will be required to show his/her:

- Passport or identity card
- Visa (if required)
- Confirmation of enrolment from Anglo-Continental
- Copy of the bank's transfer confirmation, or other evidence that you have paid the fees to Anglo-Continental or its Agent

Student travel insurance

For your protection and peace of mind, your son/daughter should have comprehensive travel insurance which should include any possible cancellation or curtailment charges. Such insurance may be obtained through Anglo-Continental or your own travel adviser. For further information visit: www.anglo-continental.com/enrolment

Lesson duration

All lessons are of 45 minutes' duration.
20 lessons per week = 15 hours.

Declaration form - Young Learner and Teenager Courses

For your son/daughter's security and well-being, it is essential that you complete the Declaration form on pages 29 and 30. Please send it to our Agent in your country or to Anglo-Continental, to arrive no later than 10 days before the date of course commencement.

Declaration form for Vacation students aged 16-17 years old

As a school accredited by the British Council and the Independent Schools Inspectorate (ISI), Anglo-Continental must follow strict regulations regarding the acceptance of students under 18 years of age. Therefore, if your son/daughter is under 18 years of age at the time he/she attends the course, we will send you the Declaration form for students 16 and 17 years of age enrolled on Vacation Courses. Please send the completed form to our Agent in your country or to Anglo-Continental, to arrive no later than 10 days before the date of course commencement.

Student Support and medical assistance

- Arrangement of emergency medical and dental treatment as provided by the British National Health Service
- Medical services and assistance with personal problems

Student care and security

- High level of supervision for all organised activities
- Safety checks
- All Young Learners are fully supervised during the school's scheduled programme and when they are with the homestay family. Young Learners/Teenagers aged 14 - 16 are supervised at all times, except if we have received written permission from the parent/guardian for them to go out unaccompanied.

Health and safety

In all our activities, we pay particular attention to the health, safety and well-being of our young learners.

Our priorities include:

- A high ratio of staff to students for close supervision of every school activity
- Activities appropriate to students' ages and capabilities
- Comprehensive arrangements for welfare and medical care
- Escorted airport transfers on arrival and departure
- Supervised door-to-door car service between homestay accommodation and the course centre (Young Learner and Teenager Courses only - where selected)
- Careful selection of homestay accommodation
- Regular safety checks of students under 18 years of age

School and national holidays

Anglo-Continental is closed on official national holidays declared by the British Government. Those scheduled for 2019 are:
1 January, 19 April, 22 April, 6 May, 27 May and 26 August.

If your entry date coincides with an official holiday, your accommodation will still be reserved for you from the Sunday before your course commences, and we would advise you to plan to arrive on that day. Your course will begin with the entry test on the next working day following the holiday.

No compensation, fee reductions, refunds, credit, additional lessons or extension of the course can be given for days when the school is closed because of official holidays.

UK visa requirements

If you are unsure whether your son/daughter will need a visa to study in the UK, visit the Home Office website: www.gov.uk/visas-immigration. You may also wish to consult your nearest British Embassy or Consulate.

If your son/daughter requires a visa in order to study in the UK, we strongly recommend that you apply for the course as early as possible as the application procedure may take several weeks to complete. Before issuing a visa letter, Anglo-Continental must be in receipt of a deposit of £ 500 (deductible when you pay your fees) or the full amount of the fees due.

It is your responsibility to ensure that your son/daughter applies for and maintains the correct type of immigration status to allow him/her to study at Anglo-Continental for the entire period of his/her course(s). You must ensure that all details on his/her confirmation documents (including the visa letter) issued by Anglo-Continental are correct before he/she applies for his/her visa. Anglo-Continental cannot be held liable for any errors that occur during the visa application process. We strongly recommend that you send a scanned copy of your son/daughter's visa to us to check prior to his/her departure to the UK.

Refund guarantee

Should the application for a visa be refused, we will refund any published fees paid by you (after deduction of an administration charge of £ 100) provided that you send us a copy of the letter of refusal before the intended start date of the course.

Any additional charges for services provided by a third party (such as courier services) are not covered by this guarantee.

Anglo-Continental's Home Office Licence Number

Anglo-Continental holds Tier 4 Sponsor status on the Home Office Register of Sponsors. Anglo-Continental's licence number is 52F9Y0GV5. Further details are available on our website: www.anglo-continental.com/visas.html

Anglo-Continental English Language Levels	CEF*
Beginner to Elementary	A1
Pre-Intermediate	A2
Intermediate	B1
Upper Intermediate	B2
Advanced	C1
Proficiency to Near Native	C2

* CEF = Common European Framework

Other Anglo-Continental Publications



Adult Prospectus

- General English Programme
- Academic Study Programme
- Examination Programme
IELTS, TOEFL, Cambridge First Certificate and Cambridge Advanced Certificate
- Business and Specialised Programme
English for Business, Finance, Management, Marketing and Sales, Medical English, Law and the Oil and Gas Industry
- Executive Programme
Mini Groups, Mini Group plus English for Business and Specialised Programmes, Mini Group plus Individual Tuition and Intensive Individual Tuition
- Club 50+ Programme
- Teacher Training Programme
Language and Methodology of English Teaching
- Professional and Technical Programme
English for Health and Safety, Maritime Personnel, Engineering, Hospitality and Tourism, Air Force Personnel, Naval Personnel, Immigration and Security Officers, Army Personnel and Police Forces



Aviation Prospectus (available online only)

- Test of English for Aviation Personnel (TEAP)
- Introduction to Aviation English Course
- English for Pilots and Air Traffic Controllers - ICAO Course 291
- Professional Training Course for Raters
- Teaching Methodology Course for Aviation English Teachers
- Aviation English Language Training Courses - English for Aeronautical Information Services (AIS), Air Navigation, Aviation Management, Aviation Security, Cabin Crew, Engineering in Aviation, Meteorology and Ground Personnel



Teacher Training Prospectus (available online only)

- TEFL Taster Days
- Cambridge Certificate in English Language Teaching to Adults (CELTA) Courses

69 years' experience in teaching English to the world!



Anglo-Continental

29-35 Wimborne Road, Bournemouth BH2 6NA, England

Telephone (GB code) +(0)1202 55 74 14

Email english@anglo-continental.com

Website www.anglo-continental.com



Member of
**BUSINESS
ENGLISH UK**
for Professional Training

Accredited by the
**BRITISH
COUNCIL**
for the teaching
of English in the UK

